

Proposed Project at Mouza-Ichlabad, J.L. No-75, L.R. Plot No-132, L.R. Khatian No- 14297, 14298, 14299, 14300, 14301, 14302, 14303, 14304, R.S. Plot No-2050 (Regarded as L.O.P. No-66), Mahalla-Sripally, Holding No-118, Ward No-10, under Burdwan Municipality, P.S.-Bardhaman, District-Purba Bardhaman

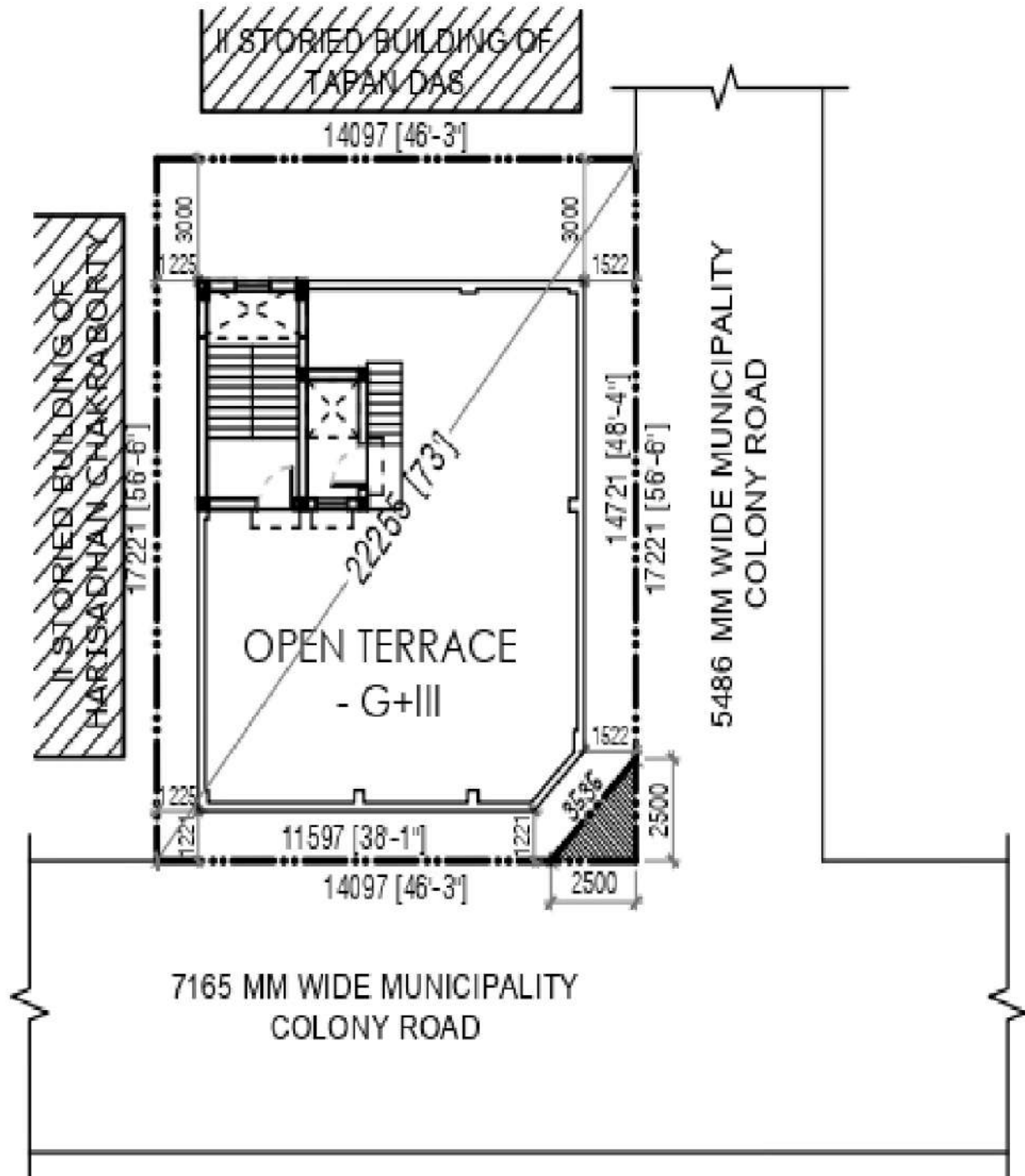

**LATITUDE : 22.914316**  
**LONGITUDE : 87.786080**

**GREEN APPY**  
*Soumitra Adak*  
**Partners**

**SIGNATURE OF OWNER**